



71 Pennywell Gardens

, New Milton, BH25 5YB

£1,150 Per Month



Road Map

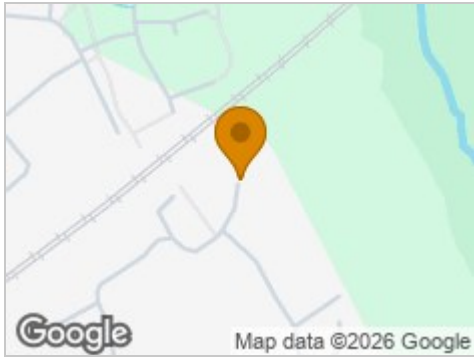

Hybrid Map



Terrain Map



Floor Plan

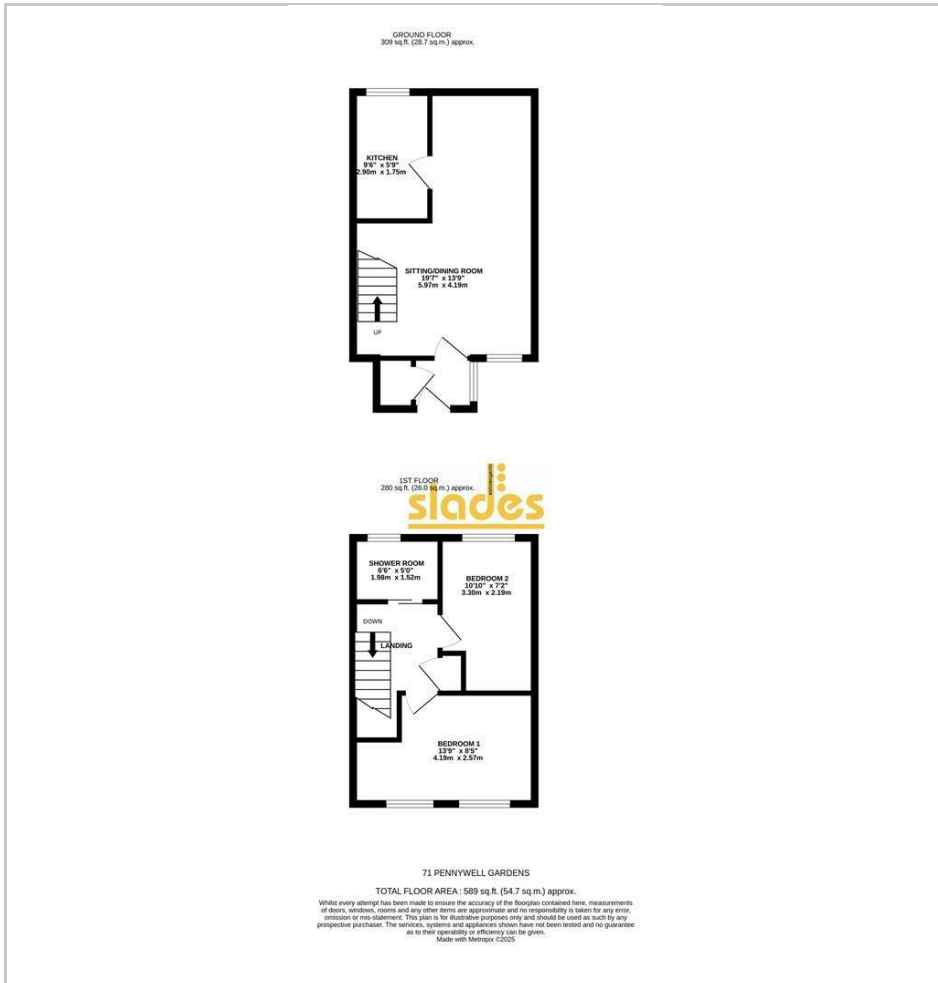

- Recently Modernised 2 Bedroom House
- Luxury Kitchen
- Spacious Open Plan Living/Dining Room
- 2 Good Sized Bedrooms
- Modern Shower Room
- New High Efficiency Heating
- Private Garden
- Ample Parking
- Available Early June 2026

Viewing

Please contact our Slades Estate Agents Office on 01202548855 if you wish to arrange a viewing appointment for this property or require further information.



Energy Efficiency Graph

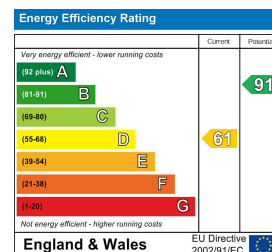

These particulars, whilst believed to be accurate are set out as a general outline only for guidance and do not constitute any part of an offer or contract. Intending purchasers should not rely on them as statements of representation of fact, but must satisfy themselves by inspection or otherwise as to their accuracy. No person in this firm's employment has the authority to make or give any representation or warranty in respect of the property.

301 Wimborne Road, Bournemouth, BH9 2AA
Tel: 01202548855 Email: info@sladesproperty.co.uk <https://www.sladesproperty.co.uk>

**An extensively modernised 2 BEDROOM end of terrace home in this sought after residential location.
Available June 2026**





